

Original BMW Accessories. Installation Instructions.



Retrofit BMW Performance E8x / E9x US Air Intake System

BMW 1 Series

BMW 3 Series

Retrofit kit number

13 72 0 444 749 BMW Performance E8x US Air Intake System

13 72 0 444 751 BMW Performance E9x US Air Intake System

Installation time

The installation time is **approx. 0.5 hours**, but this may vary depending on the condition of the car and the equipment in it.

Important information

These installation instructions are primarily designed for use within the BMW dealership organisation and by authorised BMW service companies.

In any event, the target group for these installation instructions is specialist personnel trained on BMW cars with the appropriate specialist knowledge.

All work must be completed using the latest BMW repair manuals, circuit diagrams, servicing manuals and work instructions, in a rational order, using the prescribed tools (special tools) and observing current health and safety regulations.

If you experience installation or function problems, restrict troubleshooting to approx. 0.5 hours for mechanical work and 1.0 hour for electrical work.

To avoid unnecessary extra work and/or costs, an inquiry is to be sent straight away to the technical parts support via the Aftersales Assistance Portal (ASAP).

Quote the following information:

- Chassis number,
- Retrofit kit part number,
- detailed description of the problem,
- Any work already carried out.

Do not archive the hard copy of these installation instructions since daily updates are made by ASAP!

All pictures show LHD cars; proceed accordingly on RHD cars.

All illustrations show the installation process for the E 82; proceed in a similar fashion for all other cars.

Pictograms



Denotes instructions that draw your attention to special features.

◀ Denotes the end of the instruction or other text.

Special tools required

None

Table of contents

Section	Page
1. BMW Performance E8x / E9x US Air Intake System parts list	3
2. Preparatory work	4
3. BMW Performance E8x / E9x US Air Intake System installation	5
4. Concluding work and coding	9

1. BMW Performance E8x / E9x US Air Intake System parts list

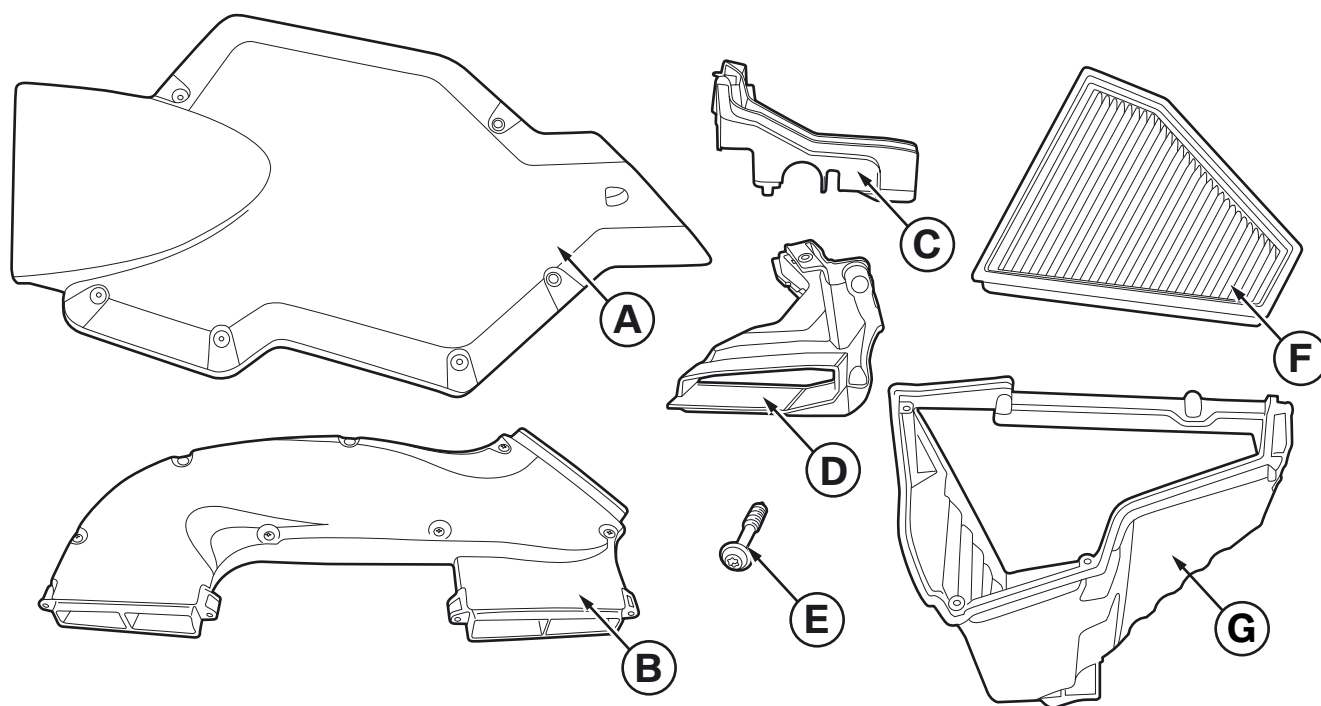

081 0056 V

Legend

- A** Upper section of intake filter housing
- B** Carbon intake channel
- C** Bonnet seal
- D** Air guide
- E** Torx screws (5 x)
- F** Sport air filter insert
- G** Front section of intake filter housing

2. Preparatory work

	ISTA No.
Conduct a brief test	---
Disconnect negative pole of battery	12 00 ...
The following components must be removed first of all	
Remove the intake filter housing	13 71 000

3. To install the BMW Performance E8x / E9x US Air Intake System

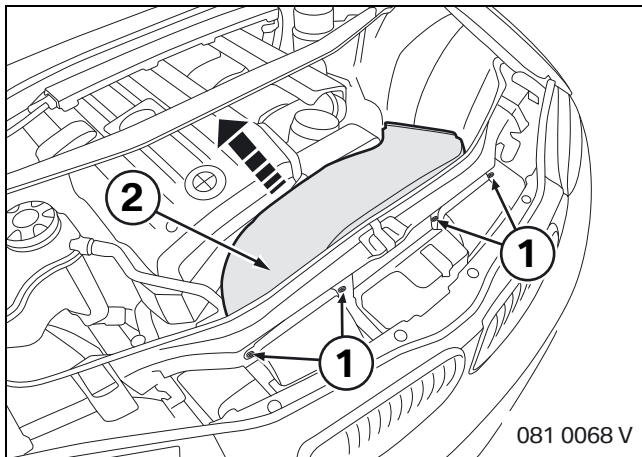

Unscrew the Torx screws (1) on both sides.

 Reuse the Torx screws (1) when installing the carbon intake channel. ◀

Pull out the standard air intake channel (2) to the rear.

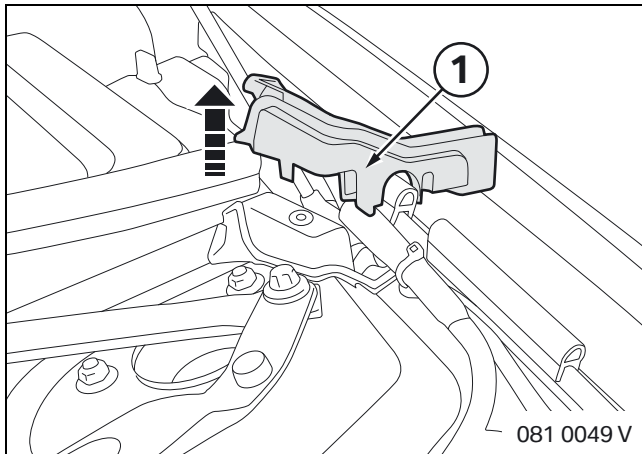

Pull the bonnet seal (1) upwards (clipped).

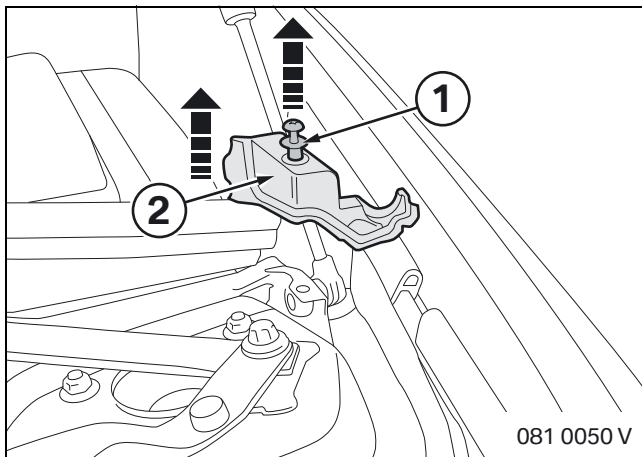

Remove the plastic expanding rivet (1) and adapter (2).

 Reuse the plastic expanding rivet when installing the new air guide. ◀

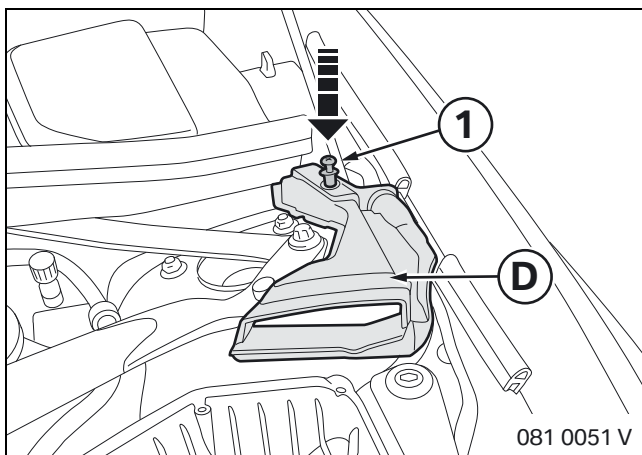

Secure the air guide **D** using the plastic expanding rivet (1).

3. To install the BMW Performance E8x / E9x US Air Intake System

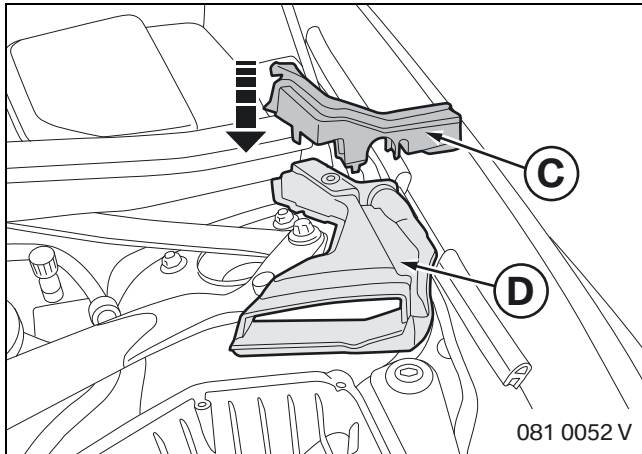

Clip the bonnet seal **C** to air guide **D**.

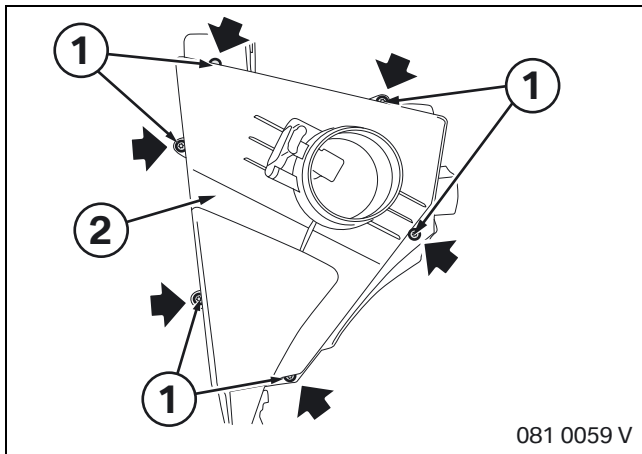

Undo the Torx screws (1) on the intake filter housing (2).

 Reuse the Torx screws (1) when installing the air filter housing. ◀

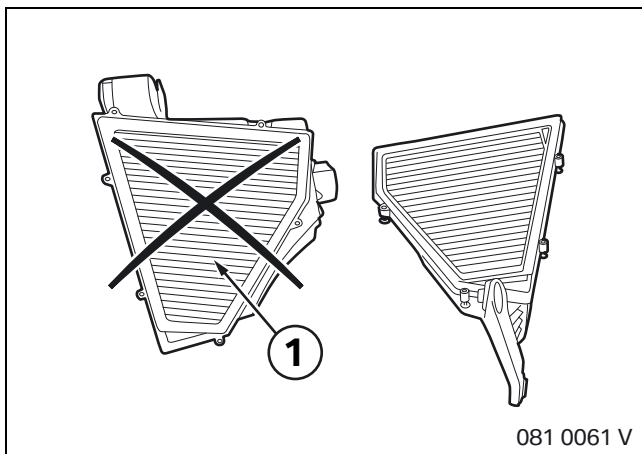

Dismantle the air filter housing and remove the front part, including the standard air filter (1).

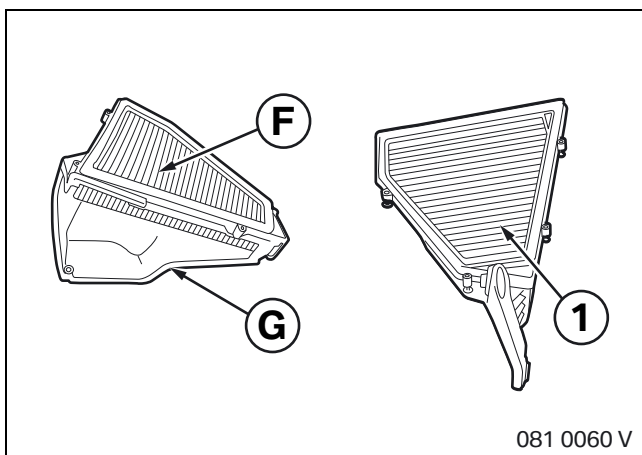

Place the Sport air filter insert **F** in the new front section of the intake filter housing **G** and connect to the old rear section of the intake filter housing (1).

3. To install the BMW Performance E8x / E9x US Air Intake System

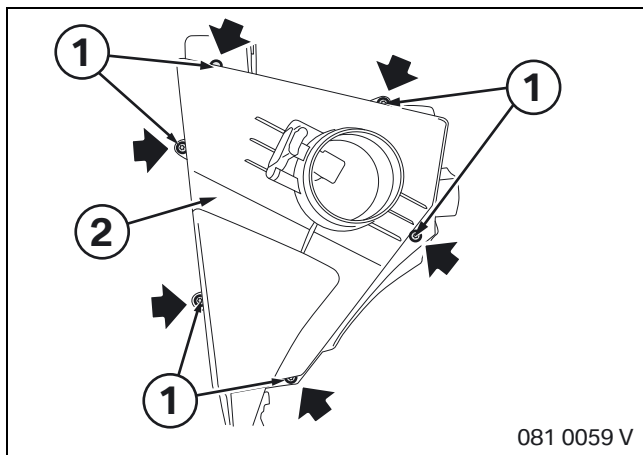

Use the existing Torx screws (1) and reassemble the intake filter housing (2).

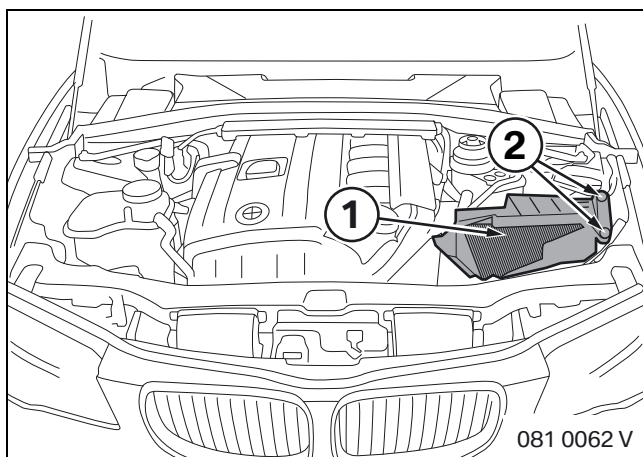

Place the intake filter housing (1) in the engine compartment and secure in place with screws (2) from the removal process (ISTA no. 13 71 000).

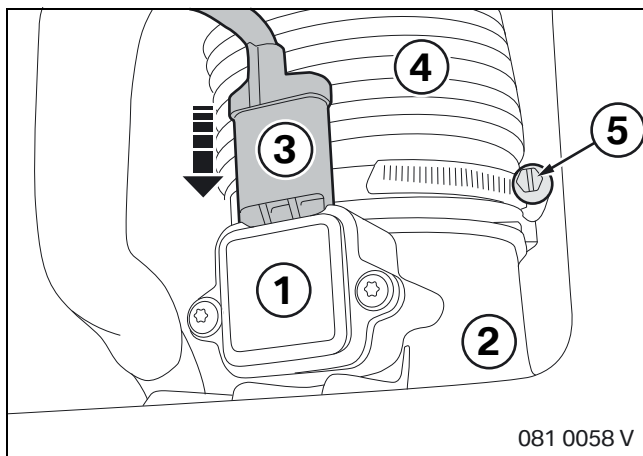

Connect the mass airflow meter (1) to intake filter housing (2) using plug (2).

Secure air channel (4) using pipe clip (5) to the intake filter housing (2).

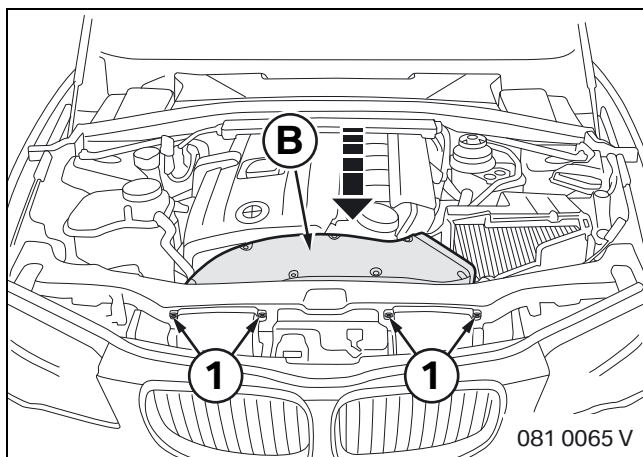

Connect the carbon intake channel **B** to the front.

Insert Torx screws (1) and secure them from falling out with 1–2 turns.



Do not screw the Torx screws (1) tight. ◀

3. To install the BMW Performance E8x / E9x US Air Intake System

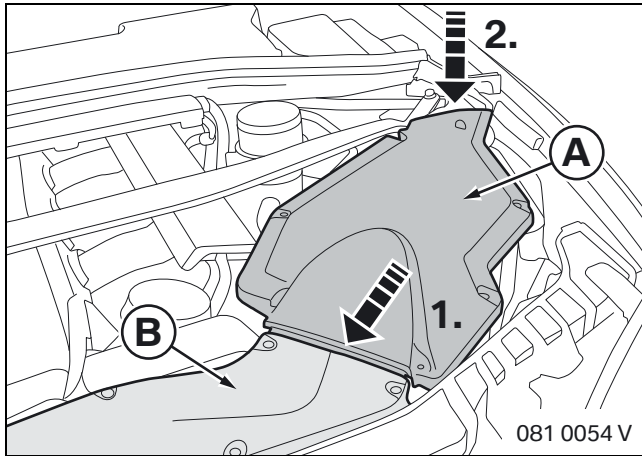

Introduce the upper section of the intake filter housing **A** into carbon intake channel **B** and then place it on top of the intake filter housing.

▶ At the rear end of the upper section of the intake filter housing **A** is a plastic hook. This must engage in the intake filter housing. ◀

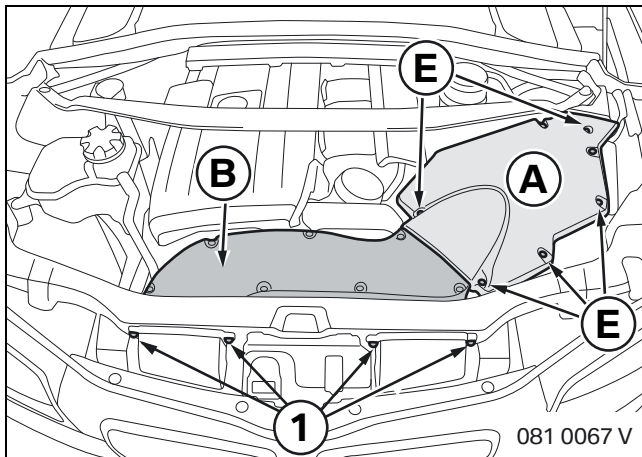

Secure the upper section of the intake filter housing **A** in place using the supplied screws **E**.

Screw the Torx screws (1) on the carbon intake channel **B** tight.

4. Concluding work and coding

This retrofit system does not require coding.

- Connect the battery
- Conduct a brief test