



# Installation Instructions

Electronics, Portable Navigation

Ver 1.0

Page 1 of 7

July 2007

Accessory  
Development

## **SUBJECT**

**NUVI PORTABLE NAVIGATION - P/N 65 90 0 429 401  
P/N 65 90 0 429 403**

## **MODEL**

3 Series (E9x):                      Select Vehicle Production 03/05 – On\*

*\*Not for vehicles with optional navigation (SA609)*

**SUGGESTED INSTALLATION TIME:      1.0 HOURS\*\***

***Total installation time may vary depending on vehicle options and equipment.***

The instructions below are developed for BMW vehicles and are not to be compared to any other existing instructions for vehicles other than BMW. No methods other than those specified in this document are to be used for installation in BMW vehicles. Left and right are determined from the driver's seat.

Carefully read all instructions and supplements before proceeding with the installation. Reference should be made to TIS for instructions dealing with a stock part of the vehicle but not stated in detail in these instructions.

The instructions were complete and up to date at time of publication; however, changes to the vehicle or installation may have occurred. Please report any problems or changes noted with the installation to BMW Technical Hotline, along with VIN, date of manufacture and as much detail as possible.

**★ ★ DO IT RIGHT THE FIRST TIME, ON TIME, EVERY TIME ★ ★**

**PARTS INFORMATION****Contents of Kit - P/N 65 90 0 429 401**

Ref.	Description	Qty	BMW Part Number
A	Mount Cover*	1	N/A
B	Mount Base*	1	N/A
C	Mount*	1	N/A
D	Wire Harness*	1	N/A
E	Wall Charger US	1	65 90 0 432 315
F	USB Cable		N/A
G	nuvi 360	1	N/A
H	nuvi Carrying Case	1	65 90 0 432 580
I	Owner's Manual	1	N/A
J	Quick Reference Guide	1	N/A
K	Mounting Screws*	4	N/A
L	2-pin connector*	1	N/A
M	Locking Tab*	1	N/A
N	4 pin connector*	1	N/A

\*Also included in nuvi installation kit 65 90 0 429 403

**WARRANTY PARTS**

Description	BMW Part Number
nuvi 360 warranty replacement head unit	65 90 0 429 402

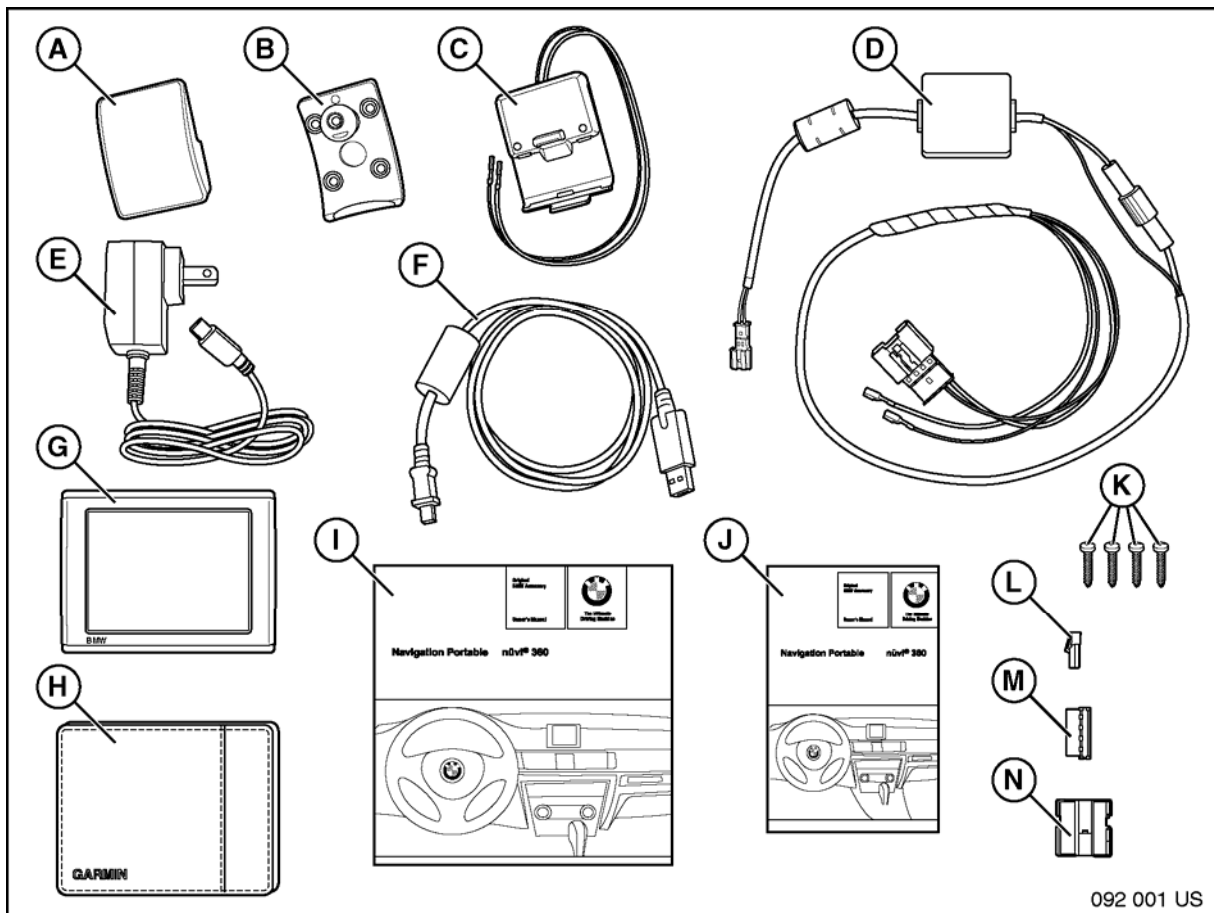

092 001 US

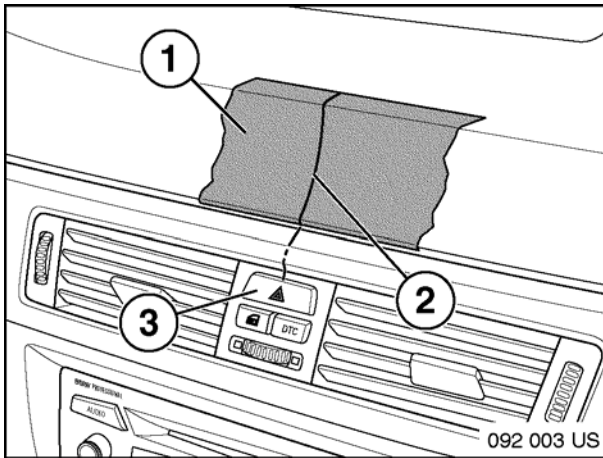
**Procedure**

1. Disconnect battery.
2. Cover dash pad with masking tape (1). Mark tape with a centerline (2) using the hazard switch (3) as a reference point, using top of triangle as the centerline.

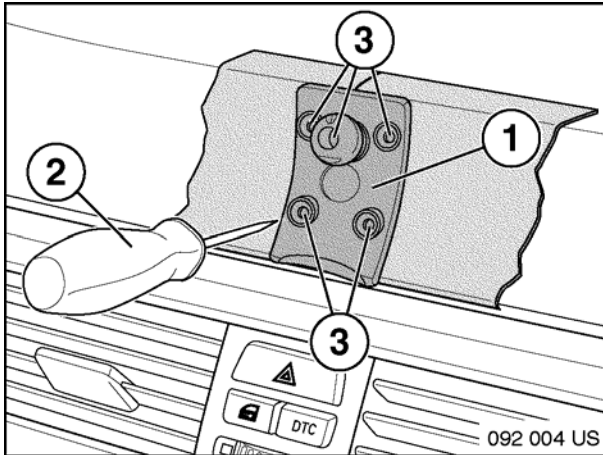

3. Center and position mounting base (1) over reference marks, indicate mounting and wiring holes (3) with a small pick (2) into tape, and dash panel.

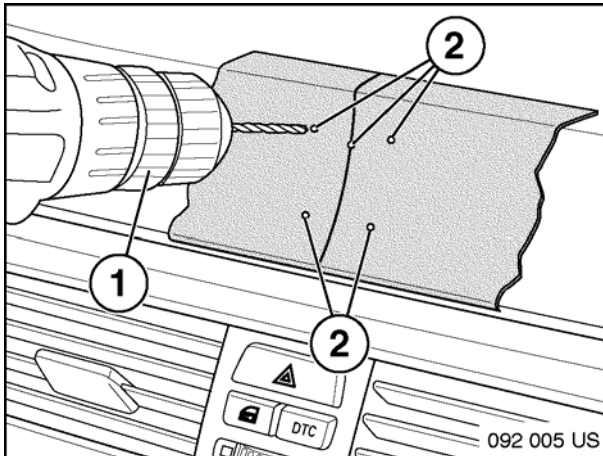

4. Drill (1) base plate mounting holes (2) with a 3mm drill bit. Drill hole for routing wires through dash pad with a 5mm drill bit.

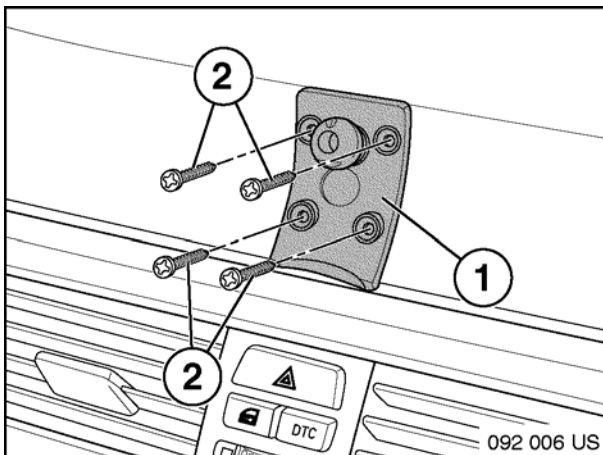

5. Remove masking tape, clean area with previously covered with tape.
6. Remove adhesive backing from mounting base.
7. Center mounting base over holes (1).
8. Install mounting screws (2).

**Caution; Do not over tighten mounting screws.**

4

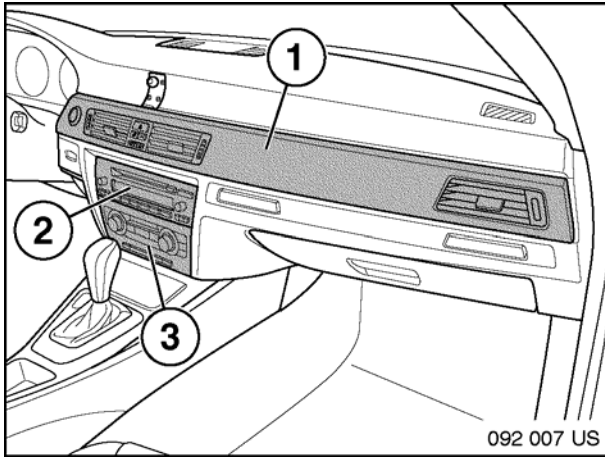

9. Remove the following components as per TIS:

(1) Dash Trim – **RA 5145 380**

(2) Radio – **RA 65 11 080**

(3) IHKA – **RA 64 11 377**

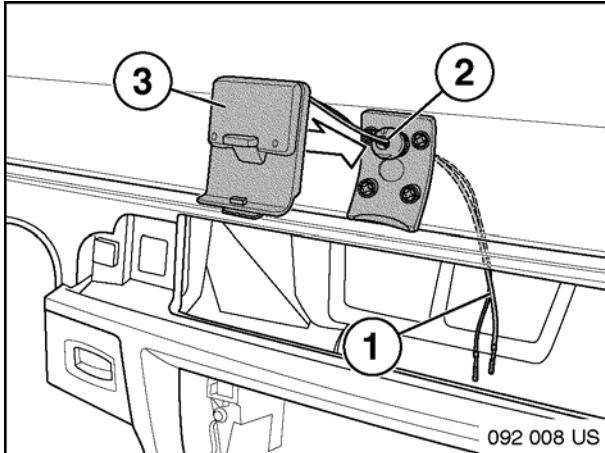

10. Route wires (1) through hole in mounting base (2), and snap cradle (3) on to base.

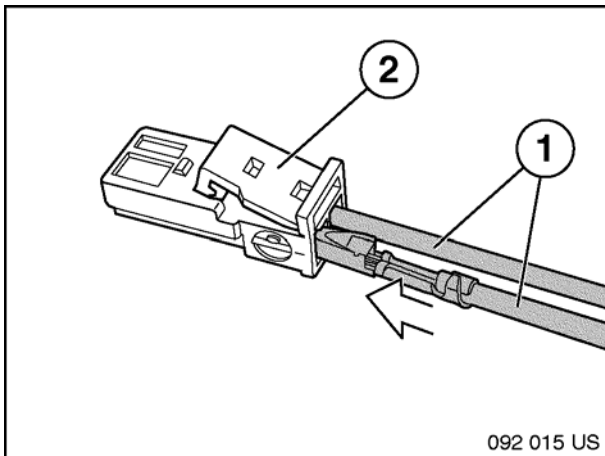

11. Insert power wires (1) from cradle, into supplied two pin connector (2), as follows:

Pin 1 - Red Wire

Pin 2 - Black Wire

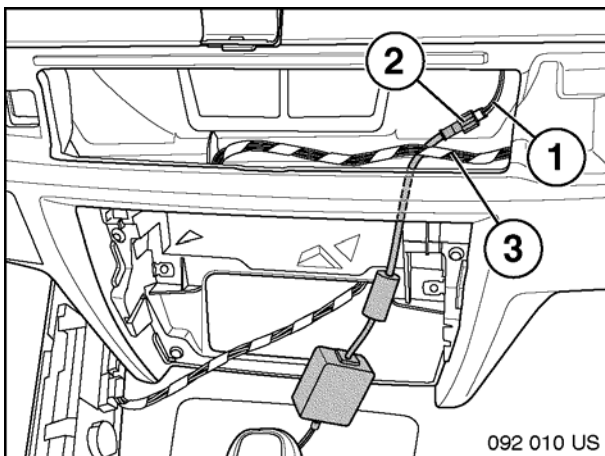

12. Route supplied harness (2) up from radio cavity, and away from air conditioning duct openings behind existing vehicle harness (3). Connect to harness (1) from cradle.

5

13. Remove the following wires (2 & 3) from connector housing (1):

Pin 12 - Brown  
Pin 15 - Red/Green

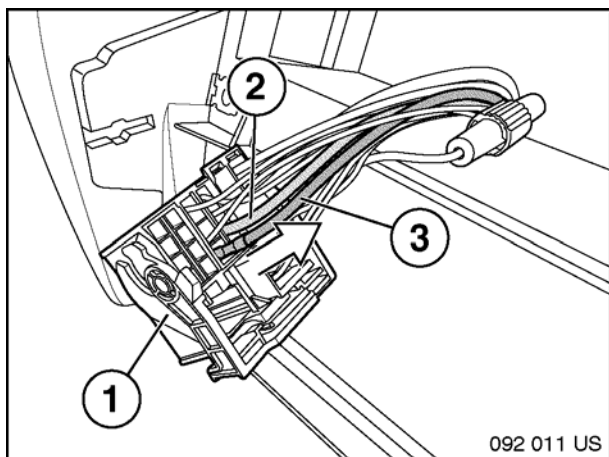

14. Install red/green wire (2) from vehicle harness into slot 1, and brown wire (3) into slot 2 of supplied 4-pin connector (1).

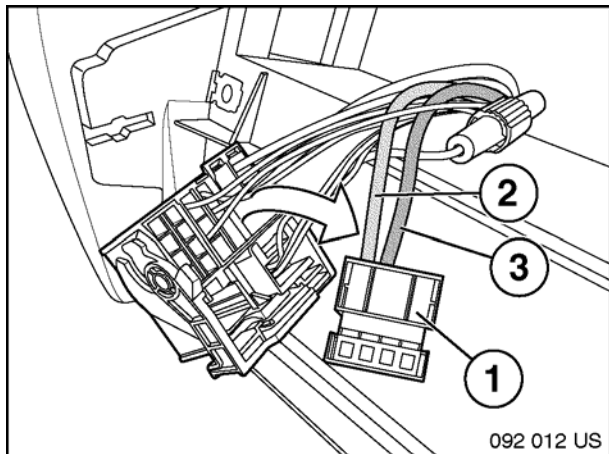

15. Install locking cover (2) onto supplied 4 pin connector (1).

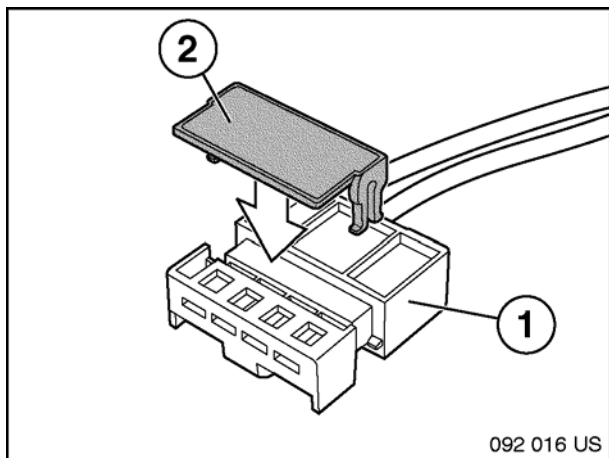

16. Connect male (1) and female (2) plugs from supplied harness together, and install red wire (3) into slot 15, and black wire (4) from supplied harness into slot 12 of radio connector.

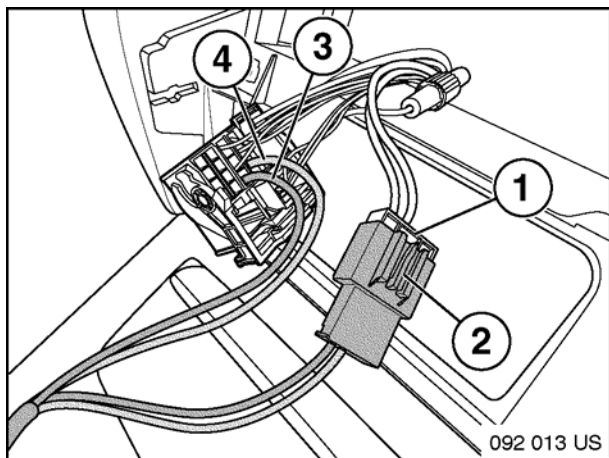

6

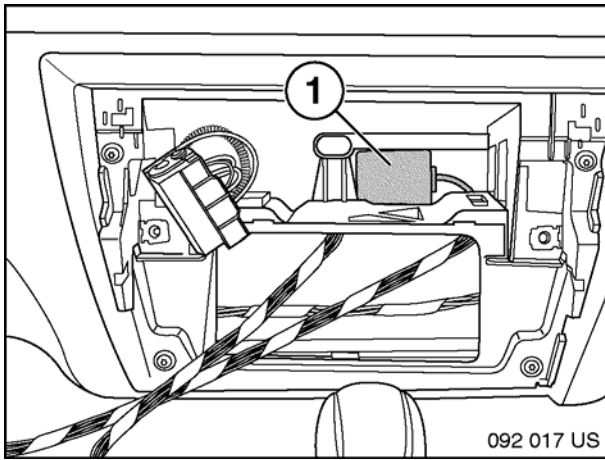

17. Secure power converter box (1) behind dash bracing in radio cavity.

**Note:** *Route excess wiring in a manner that does not interfere with other vehicle components.*

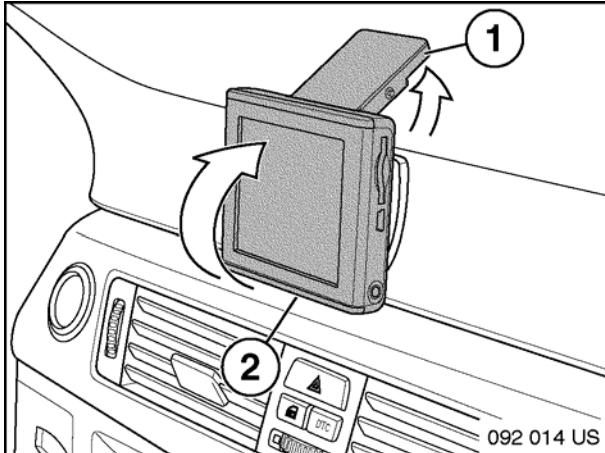

18. Raise antenna (1) on back of navigation unit, and attach to cradle by tilting bottom in (2), then snap onto upper portion to lock.
19. Re connect battery, test system functionality outdoors.

**Installation Complete**

**RETROFIT CODING**

There is no retrofit coding required for this installation.

**TROUBLESHOOTING**

<b>Issue</b>	<b>Solution</b>
nuvi unit does not power OFF when vehicle ignition is OFF.	<ul style="list-style-type: none"><li>• Installation Kit utilizes 30g power connection. Therefore unit will remain powered ON until vehicle goes to sleep (@ 4-30 minutes).</li><li>• nuvi unit can be quickly powered OFF by:<ul style="list-style-type: none"><li>- removing nuvi from mount.</li><li>- pressing Power button on nuvi</li></ul></li></ul>